

Kite

ref. **KT04G**

Pendant lamp
Lámpara colgante

SIMETECH® by arturo alvarez

INTERIOR
DESIGN
**BEST
OF
YEAR 2014**

Innovative translucent shading
lighting solution



150cm | 59,1in

9cm | 3,5in

133 x 119cm | 52,4 x 46,8in [diagonal]

Kite Collection

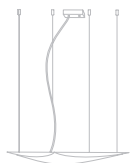

KT04

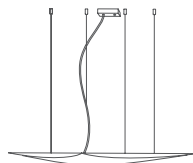

KT04G

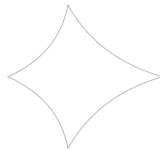

KT06

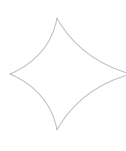

KT06G

MATERIAL FINISHES MATERIALES Y ACABADOS

LAMPSHADE

TULIPA

SIMETECH® by arturo alvarez

One color to choose
Un color a elegir



Painted steel
Acero pintado

SUPPORT AND CABLE

SOPORTE Y CABLE

Stainless steel
Acero inoxidable

Transparent cable
Cable transparente

RECOMMENDED BULBS BOMBILLAS RECOMENDADAS

230V - 50Hz

⇐⇒ G5 - Max. 4x24 W

120V - 60Hz

⇐⇒ T5 H0 Bi-pin - 4x24 W

ENERGY EFFICIENCY

EFICIENCIA ENERGÉTICA

from A+ to B
desde A+ a B

OTHER TECHNICAL DATA OTROS DATOS TÉCNICOS

NET WEIGHT

PESO NETO

10,4kg | 23l

PACKAGING

EMBALAJE

100x100x12cm | 39,4x39,4x4,7in

10,4kg | 22,9lb

ELECTRICAL FEATURES

CARACTERÍSTICAS ELÉCTRICAS



CERTIFICATIONS

CERTIFICACIONES



Kite

ref. **KT04G**

Suitable for indoor use, at 25°C

Apta para uso interior a temperatura ambiente de 25°C

Box contains | Contenido de la caja:

A - Lampshade | Tulipa [1]

B - Frame | Soporte [1]

C - Screws | Tornillos [4]

D - Wall Plugs | Tacos [4]

E - Electrical disposal | Ficha [1]

F - Tie Rod | Tensor [4]

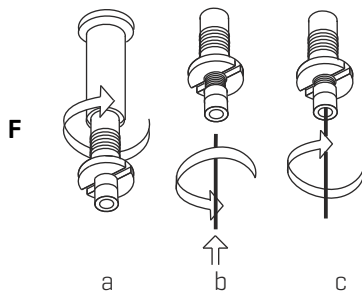
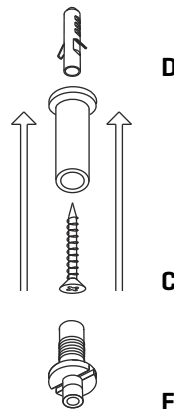
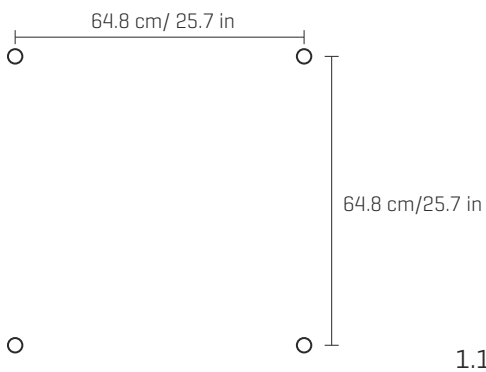
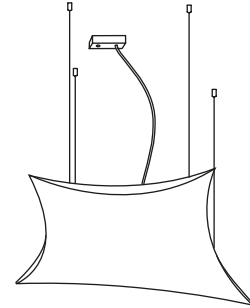

1

1.1. Drill the holes, fit the wall plugs into them and fix the metallic frame to the ceiling.
1.2. a) Screw the tie rod. b) Loosen the security nut and introduce the steel wire. c) Tighten the security nut. In order to remove the cable from the tension loosen the nut, to push it upwards and to throw of the cable.

1.1. Hacer los agujeros, colocar los tacos y fijar la pieza metálica al techo.
1.2. a) Enroscar el tensor. b) Aflojar la tuerca de seguridad e introducir el cable de acero. c) Apretar la tuerca de seguridad. Para sacar el cable del tensor aflojar la tuerca, empujarla hacia arriba y tirar del cable.

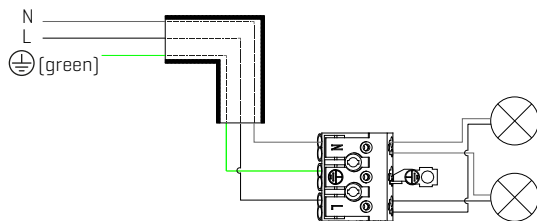

2

Pass the electric cables to the interior and do the electric connection, please follow the instructions.

Pasar los cables eléctricos al interior y hacer la conexión eléctrica dentro de la caja de conexiones, siguiendo las instrucciones.

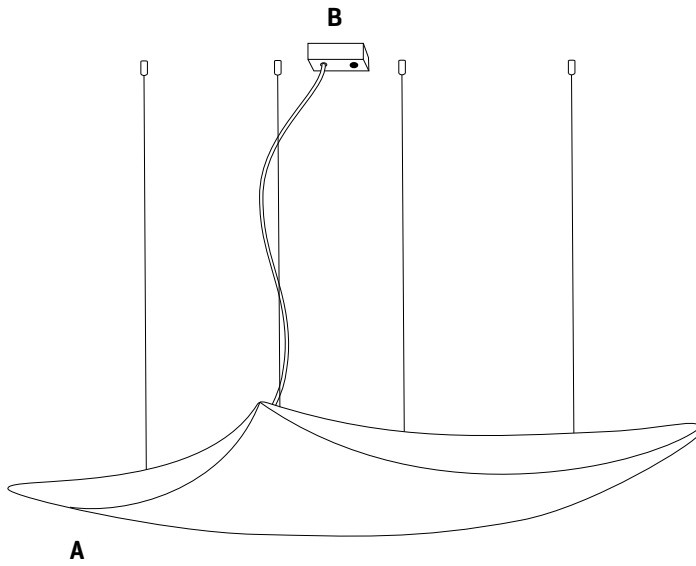

3

Once you complete all the steps, this image should be the final appearance.

Una vez completados todos los pasos, esta imagen sería el aspecto final de la lámpara.