

## Vento

ref. **VN04-1**

Pendant lamp

[Click here to download:](#)  
3D/2D, pictures, photometric curves  
and assembly instructions

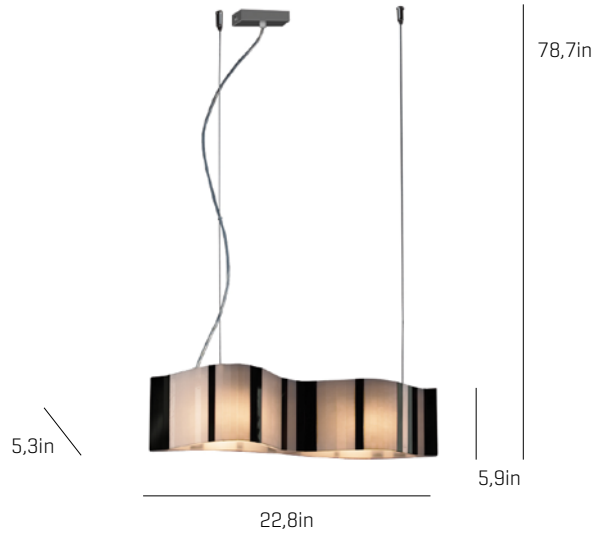

### Vento Collection



VN01



VN02



VN04-LD

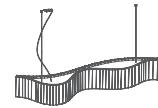

VN04-1



VN06

### MATERIAL FINISHES

#### LAMPSHADE

Glass  
One color to choose

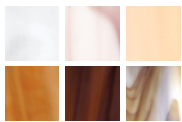

Color combinations

Pink      Brown



#### CANOPY AND CABLE

Stainless steel

Black or transparent

### LIGHT SOURCE

#### 120V - 60Hz

G9 Bi - pin - Max. 2x40 W

### OTHER TECHNICAL DATA

#### PACKAGING

31,5x11,8x11,8in  
8,2lb

#### ELECTRICAL FEATURES



#### CERTIFICATIONS



Box contains | Contenido de la caja:

- |   |                                  |
|---|----------------------------------|
| A - Whole set piece   Pieza de conexión [1] | E - Tie rod   Tensor [2]         |
| B - Canopy   Florón [1]                     | F - Wire connectors   Fichas [3] |
| C - Wall plugs   Tacos [2]                  | G - Lampshade   Tulipa [1]       |
| D - Screws   Tornillo [2]                   |                                  |

ref. **VN04-1**

Suitable for indoor use, at 77°F

Apta para uso interior a temperatura ambiente de 77°F

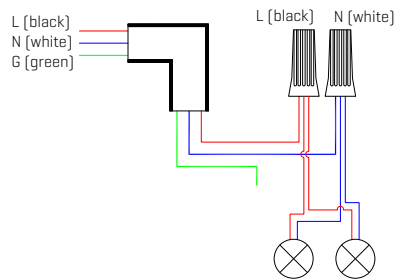
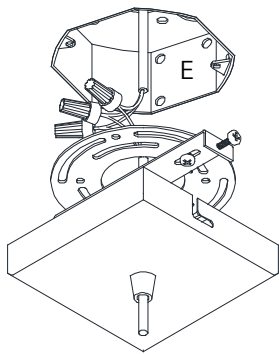

## 1

Pass the electric cables to the interior and do the electric connection inside the octagon box, please follow the instructions.

Passar los cables eléctricos al interior y hacer la conexión eléctrica dentro de la caja de conexiones, siguiendo las instrucciones.

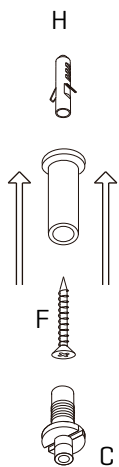

2.1

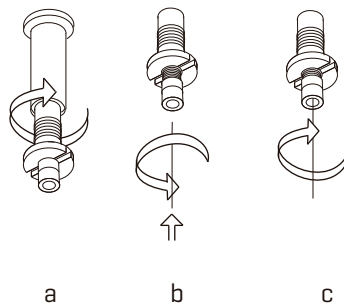

2.2

## 2

2.1. Drill the holes, fit the wall plugs into them and fix the metallic frame to the ceiling.  
2.2. a) Screw the tie rod. b) Loosen the security nut and introduce the steel wire. c) Tighten the security nut. In order to remove the cable from the tension loosen the nut, to push it upwards and to throw of the cable.

2.1. Hacer los agujeros, colocar los tacos y fijar la pieza metálica al techo.  
2.2. a) Enroscar el tensor. b) Aflojar la tuerca de seguridad e introducir el cable de acero. c) Apretar la tuerca de seguridad. Para sacar el cable del tensor aflojar la tuerca, empujarla hacia arriba y tirar del cable.

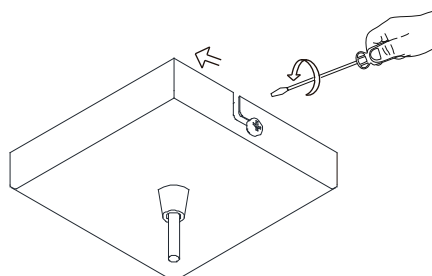
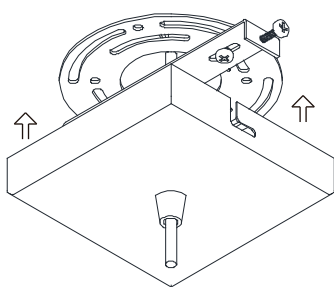

## 3

Insert the canopy in the holding piece and tight the security screws.

Encajar el florón en la pieza de sujeción y apretar los tornillos de seguridad.